









NORMAL PULLUK MONTAJ

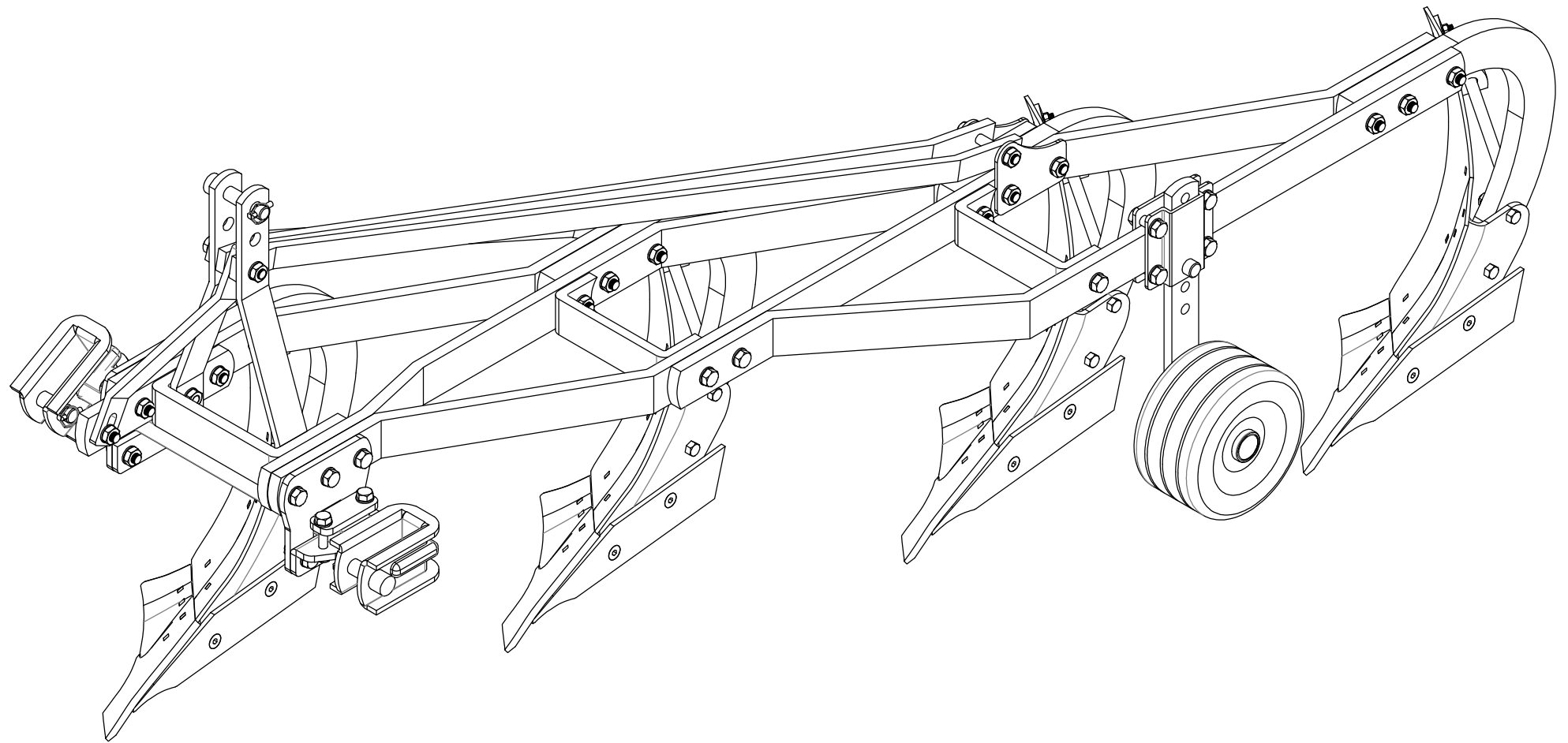

ŞASE SİSTEMİ

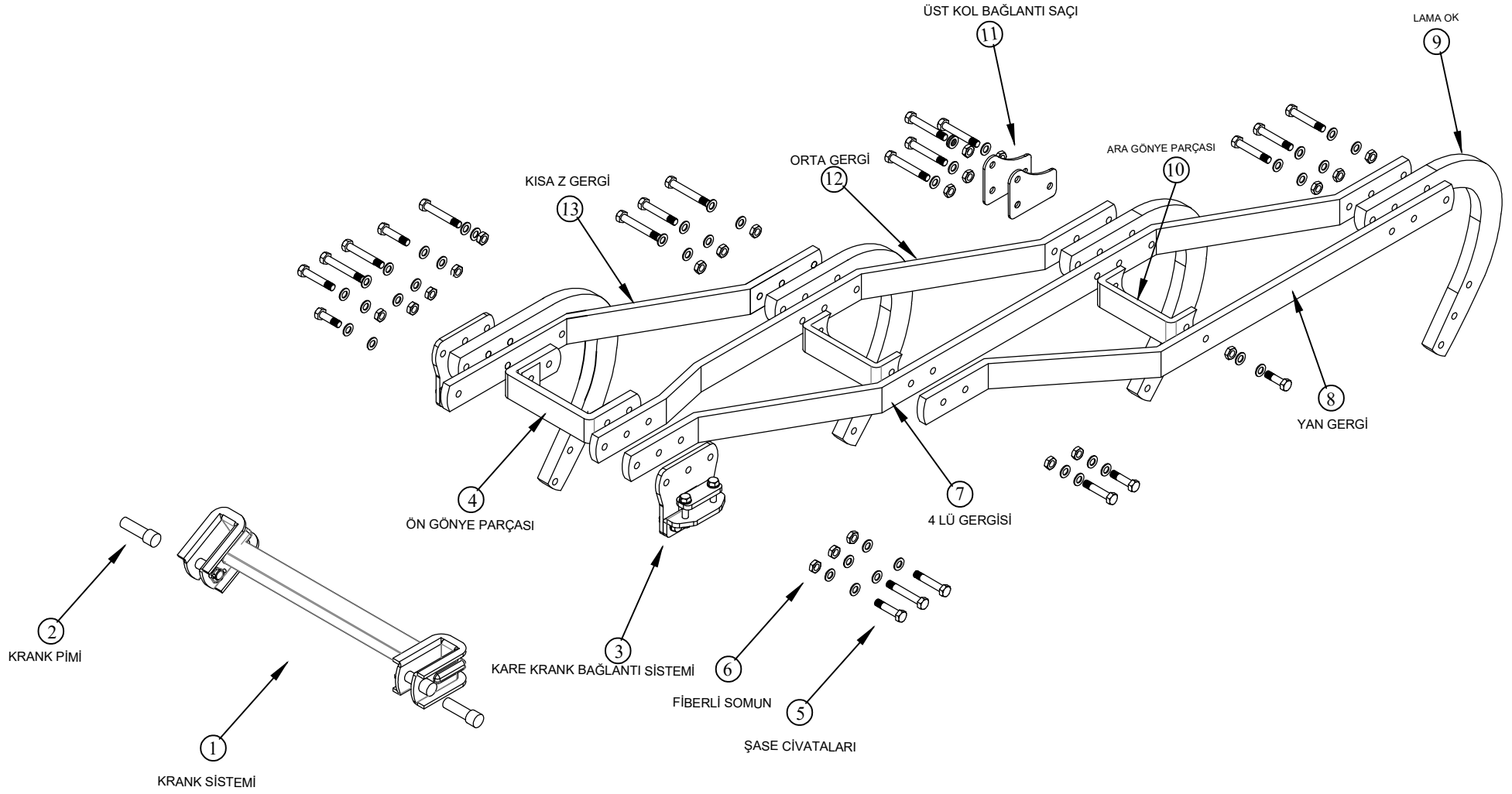

ÜST KOL VE TEKER SİSTEMİ

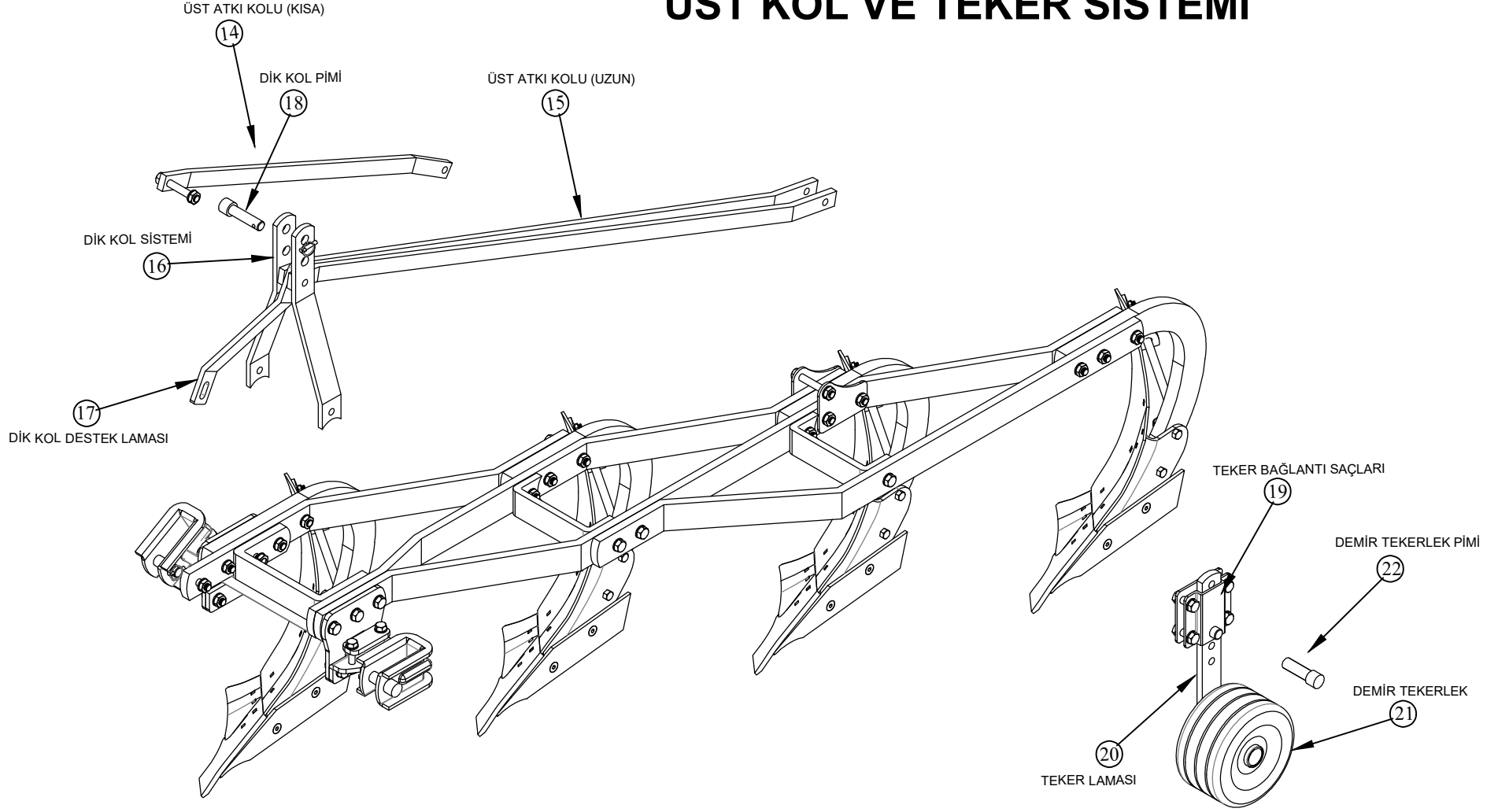

ŞASE SİSTEMİ

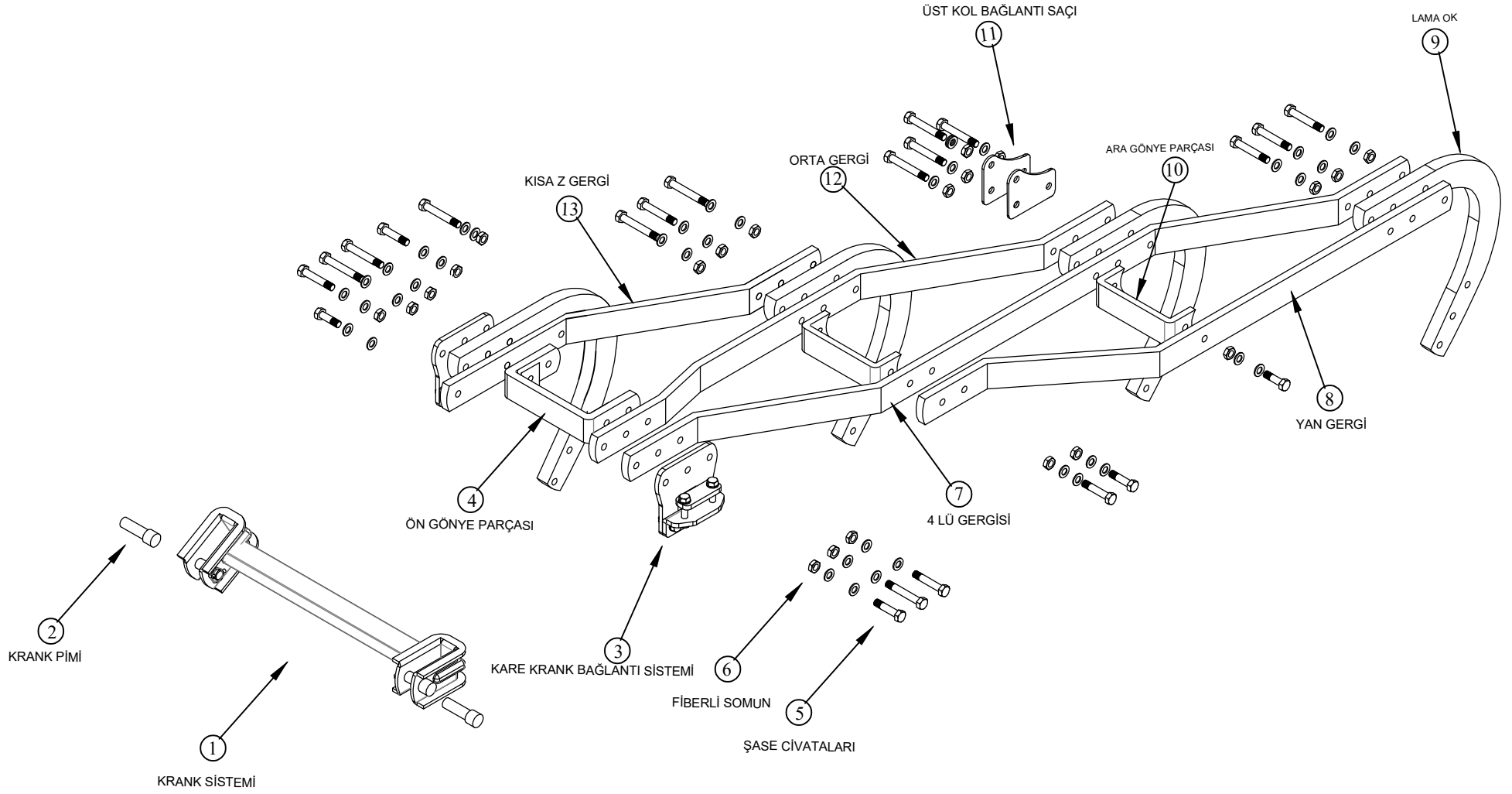

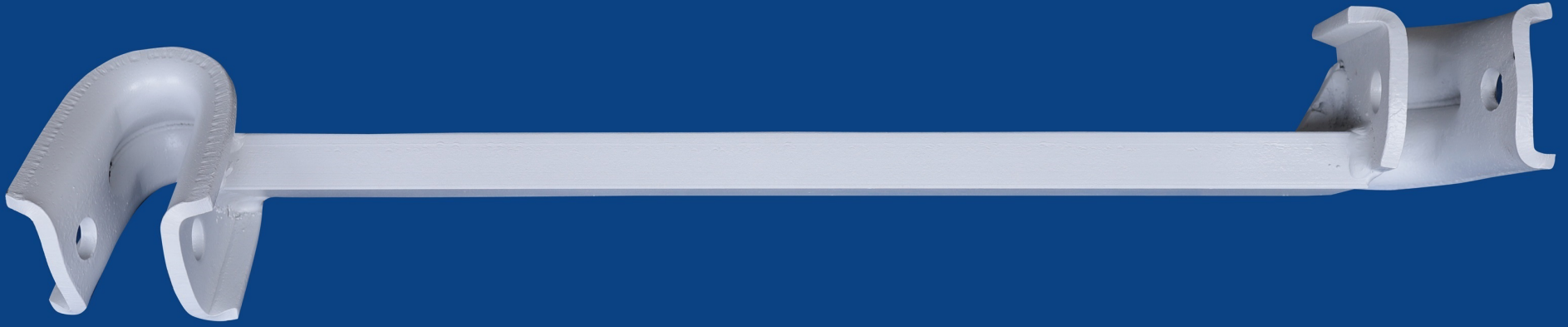

1) Krank Sistemi



2) Krank Pimi

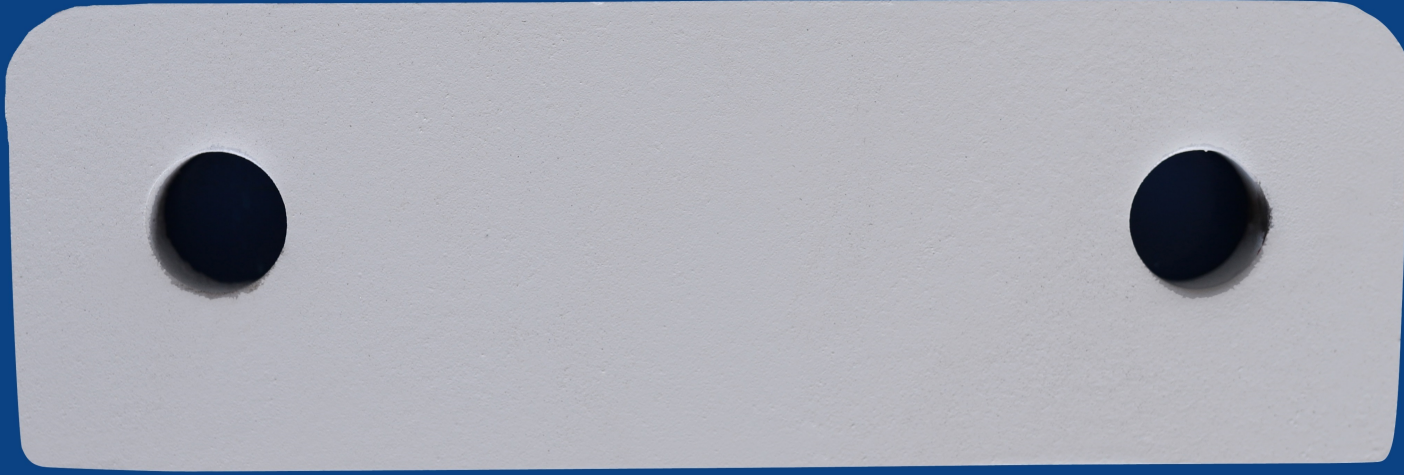

3) Kare Krank Bağlantı Sistemi - 1



3) Kare Krank Bağlantı Sistemi - 2

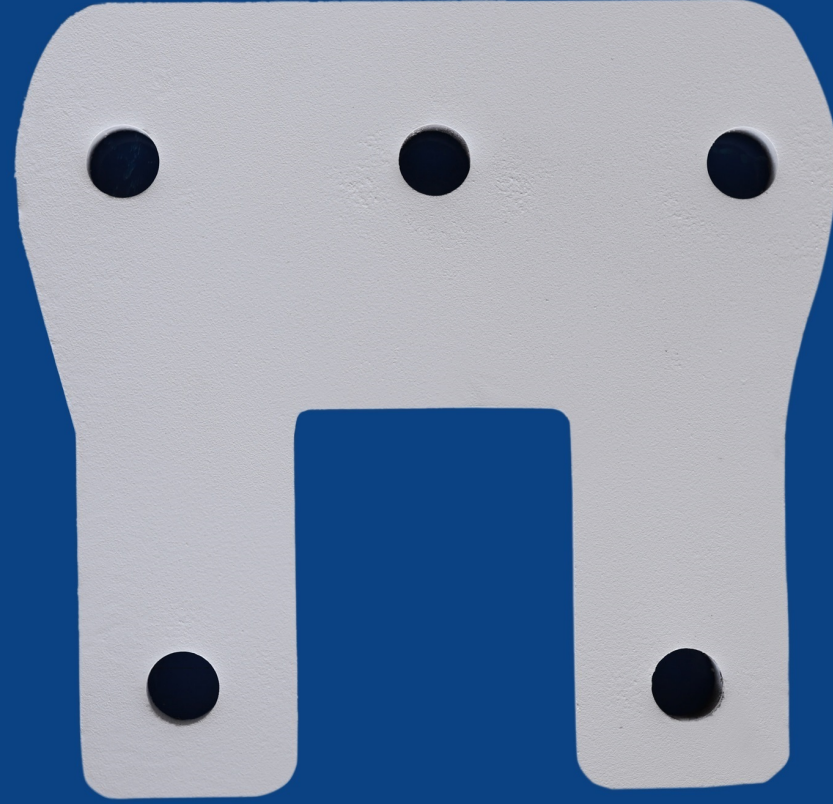

3) Kare Krank Bağlantı Sistemi - 3



4) Ön Gönye Parçası

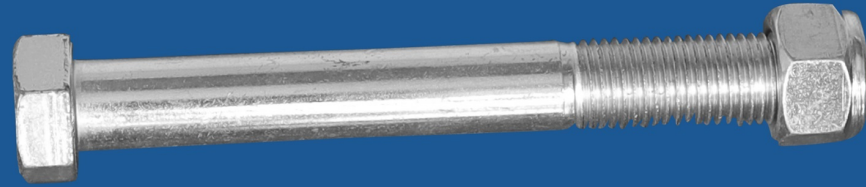

5) Şase Cıvataları



6) Fiberli Somun



7) 4 Lü Gergisi



8) Yan Gergi

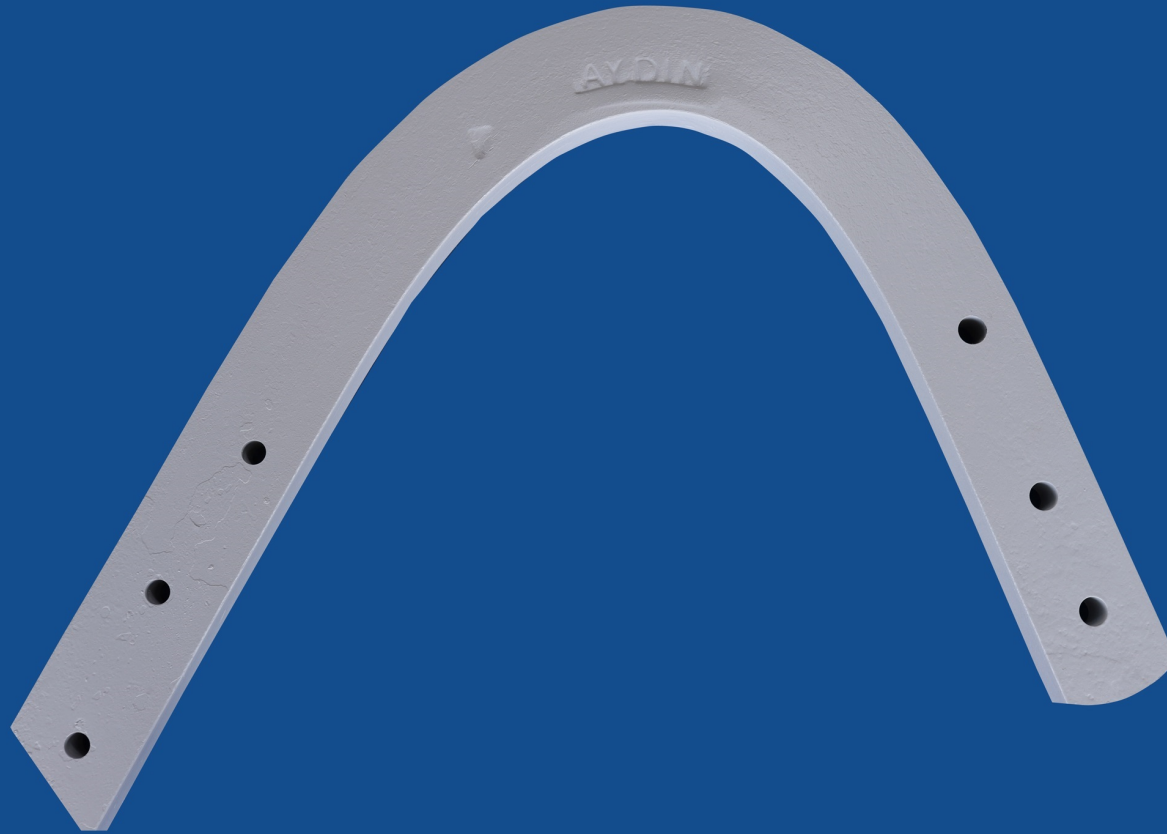

9) Lama Arka Ok

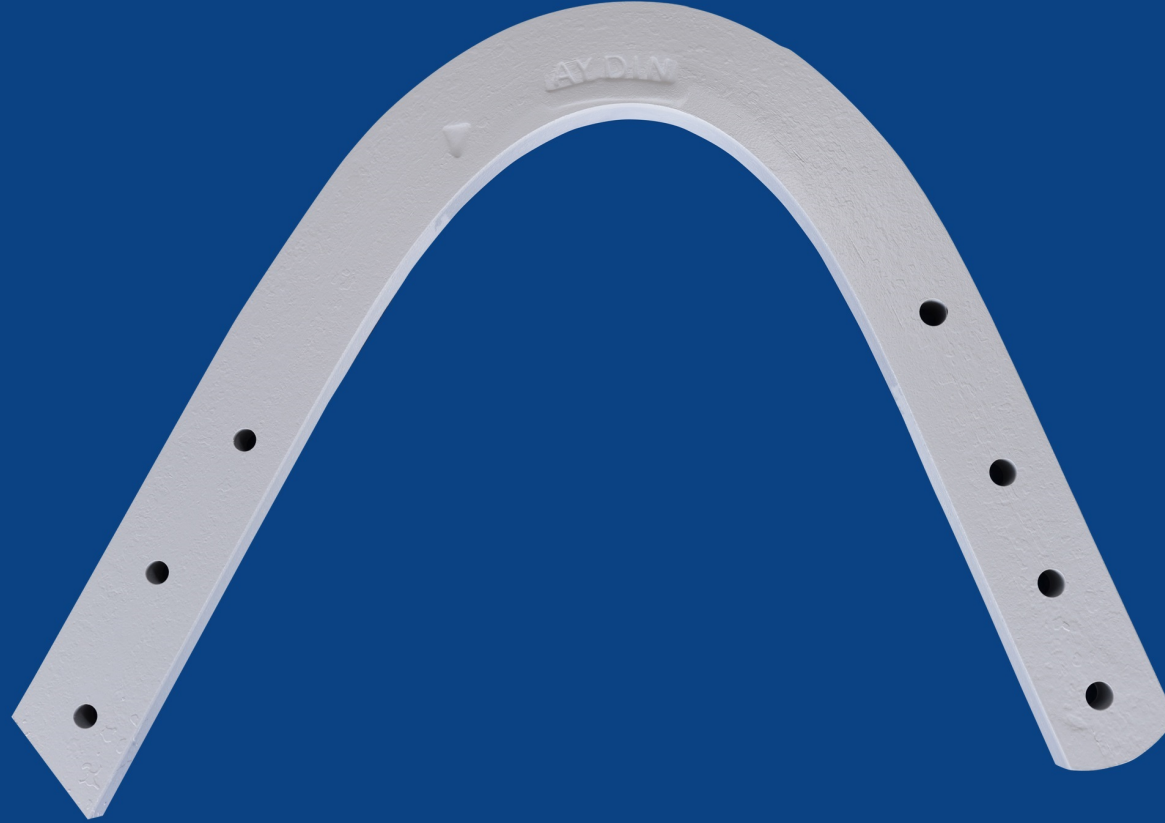

9) Lama Ön Ok



10) Ara Gönye Parçası

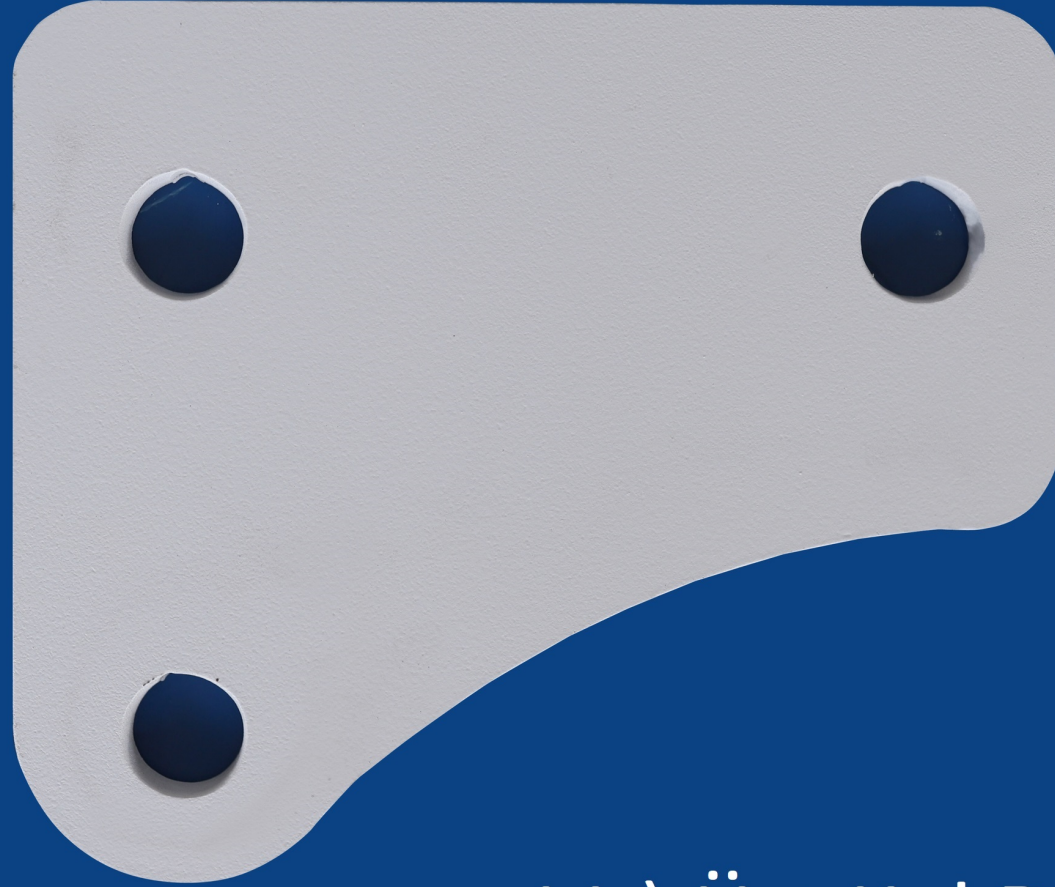

11) Üst Kol Bağlantı Sacı

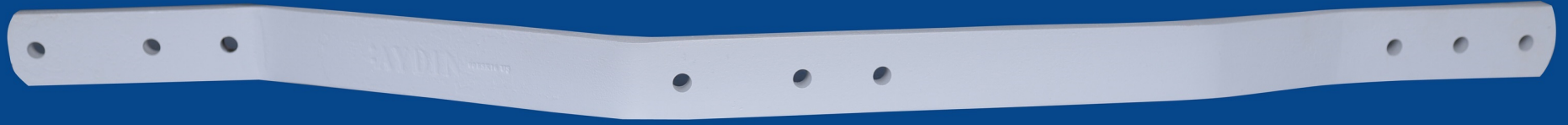

12) Orta Gergi



13) Kısa Z Gergi

ÜST KOL VE TEKER SİSTEMİ

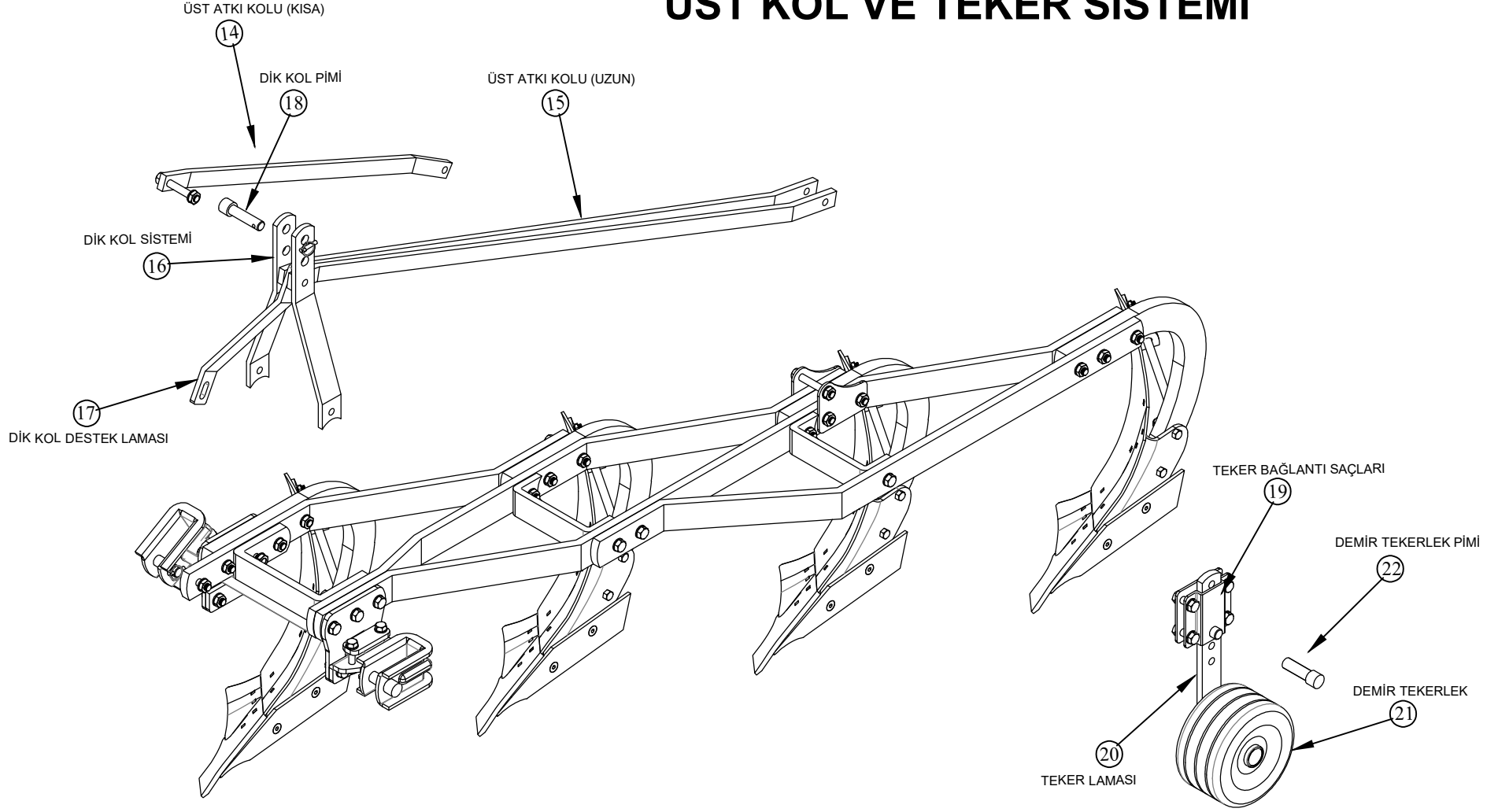



14) Üst Askı Kolu (Kısa)



15) Üst Askı Kolu (Uzun)

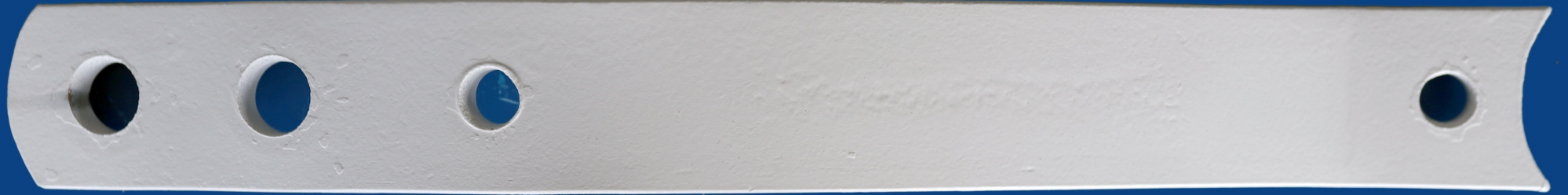

16) Dik Kol Sistemi



17) Dik Kol Destek Laması

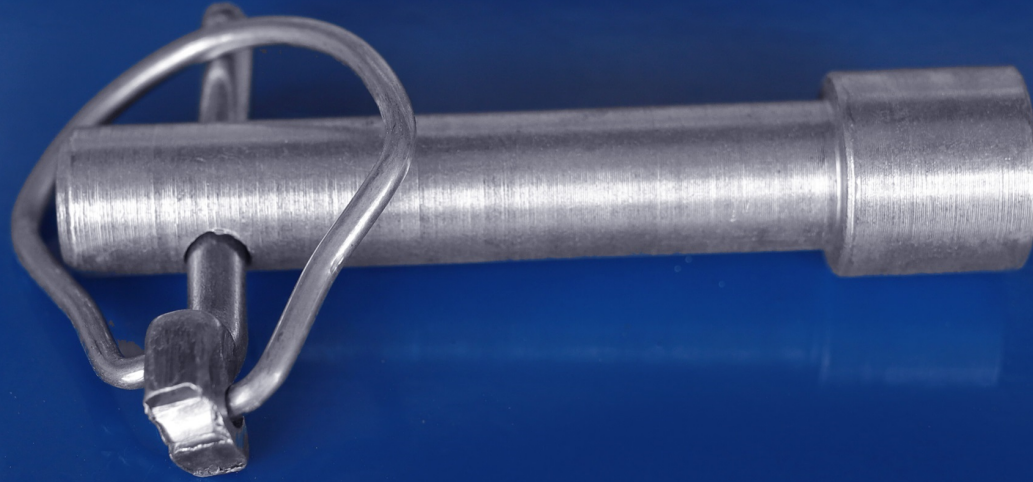

18) Dik Kol Pimi

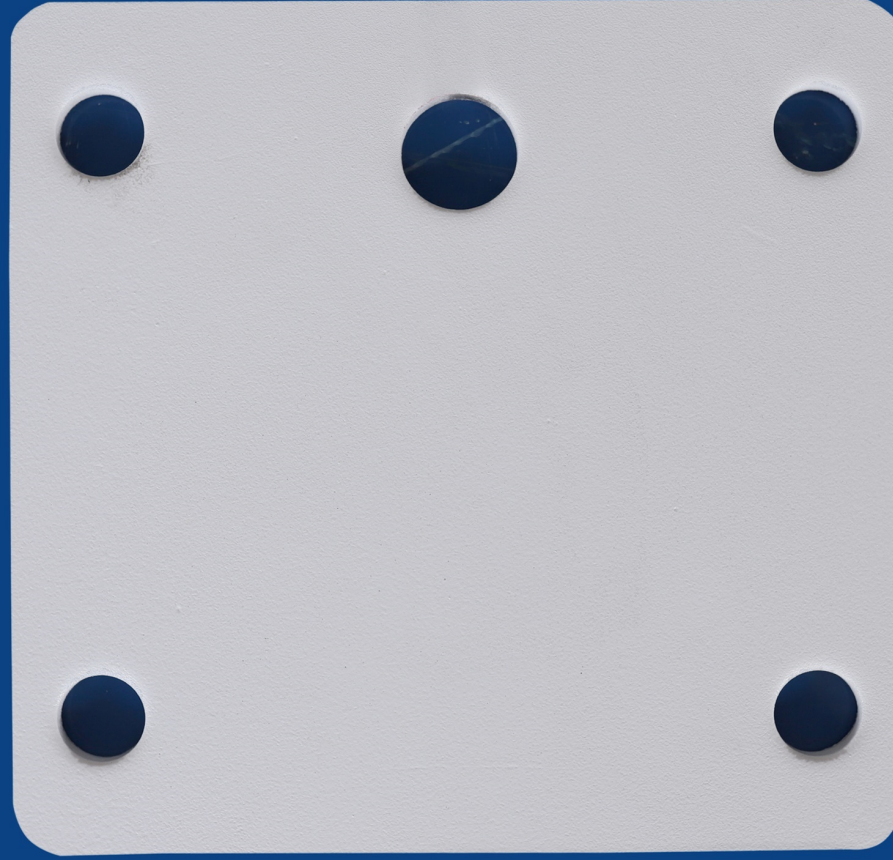

19) Tekerlek Bağlantı Sacı - 1

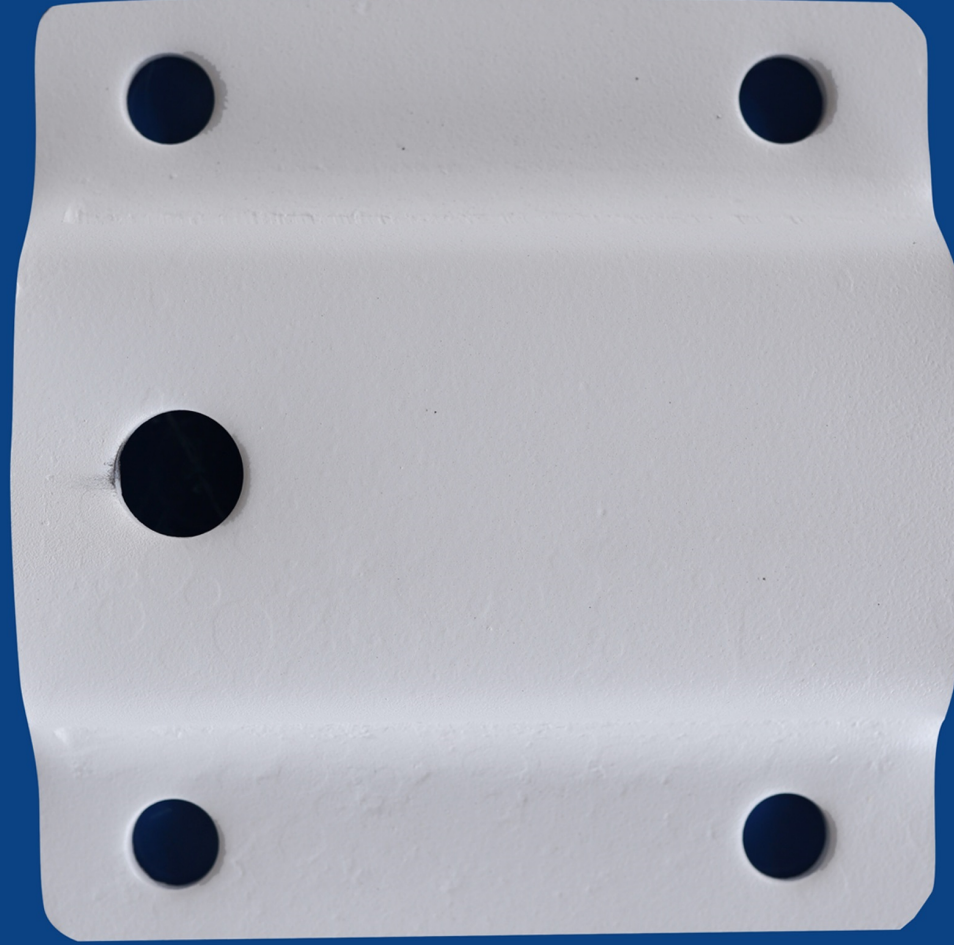

19) Tekerlek Bağlantı Sacı - 2

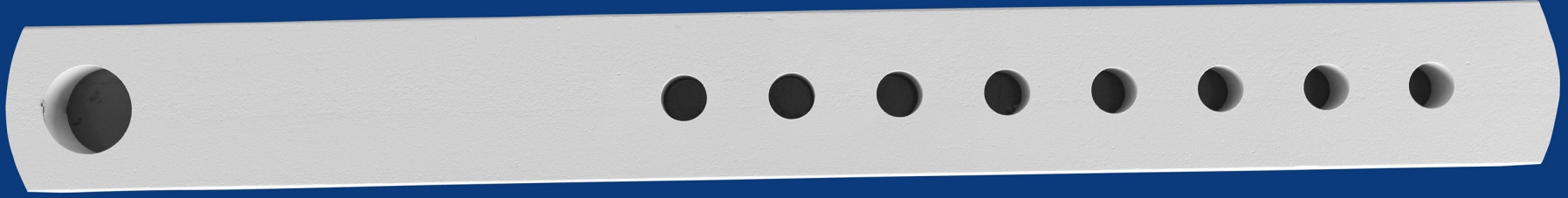

20) Tekerlek Laması

21) Demir Tekerlek



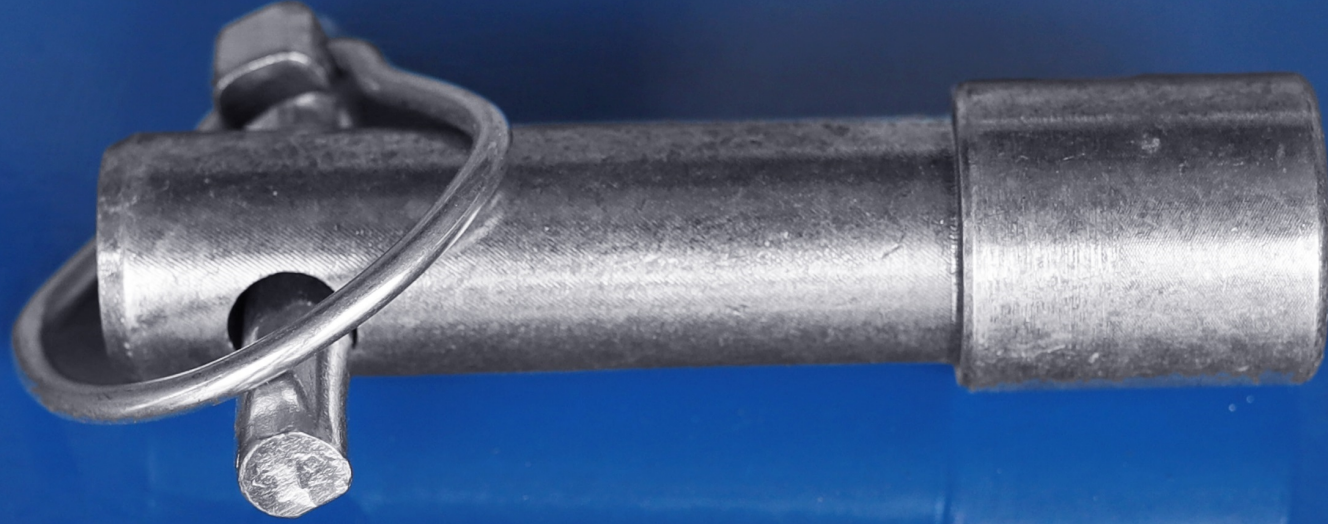

22) Demir Tekerlek Pimi

KULAK TİPLERİ

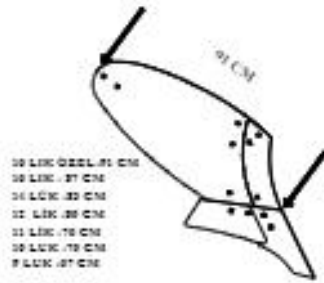

B TİPİ STANDART PARÇALI KULAK

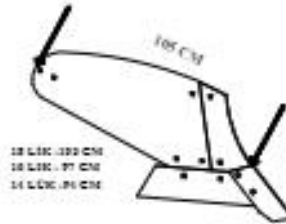

D TİPİ AVRUPA PARÇALI KULAK

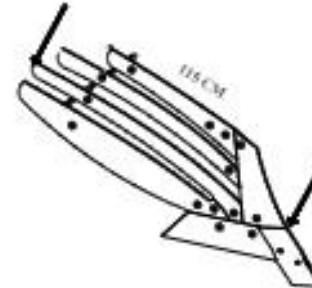

F TİPİ AVRUPA ÇİTA KULAK

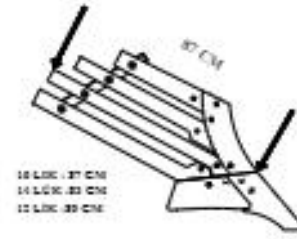

H TİPİ STANDART ÇİTA KULAK

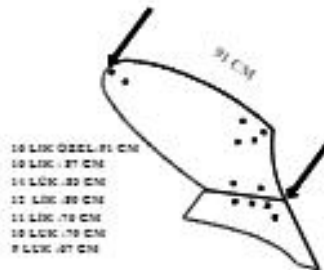

A TİPİ STANDART DÜZ KULAK

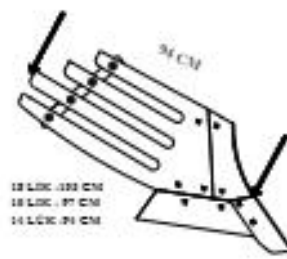

C TİPİ AVRUPA PARÇALI İZGARA KULAK

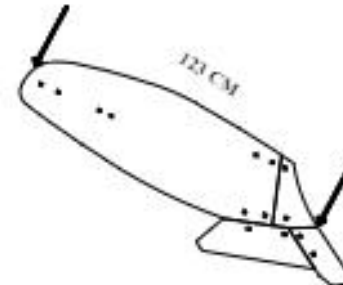

E TİPİ (123 CM) AVRUPA TAM BÜKÜK KULAK

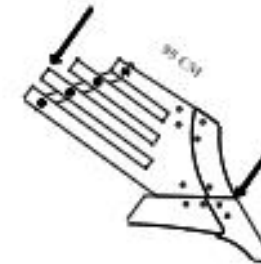

G TİPİ STANDART ÇİTA KULAK

A TİPİ KULAK MODELİ

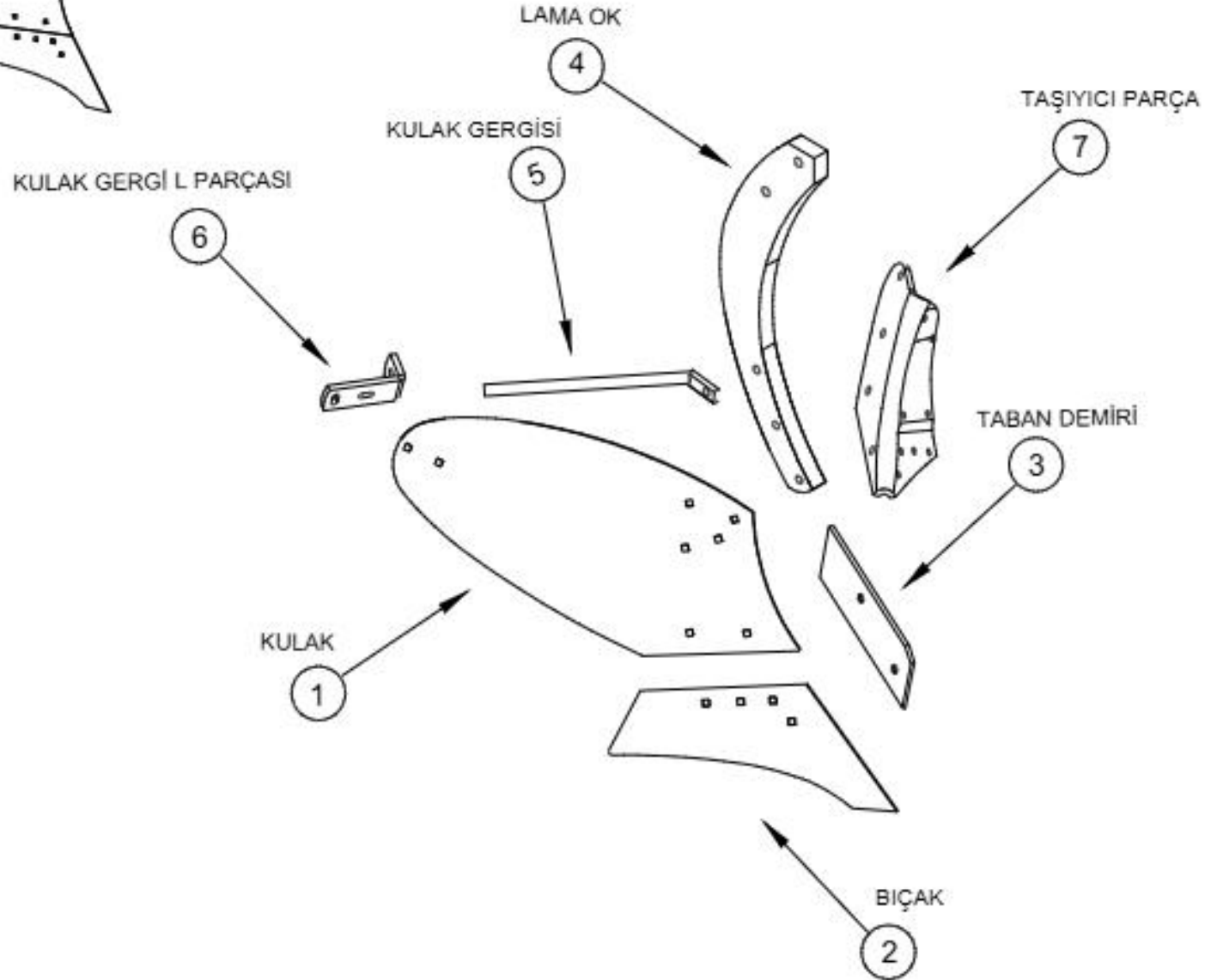
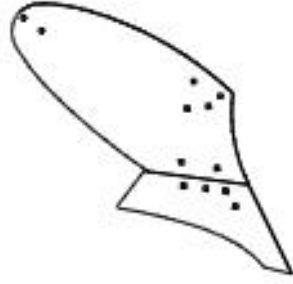

B TİPİ KULAK MODELİ

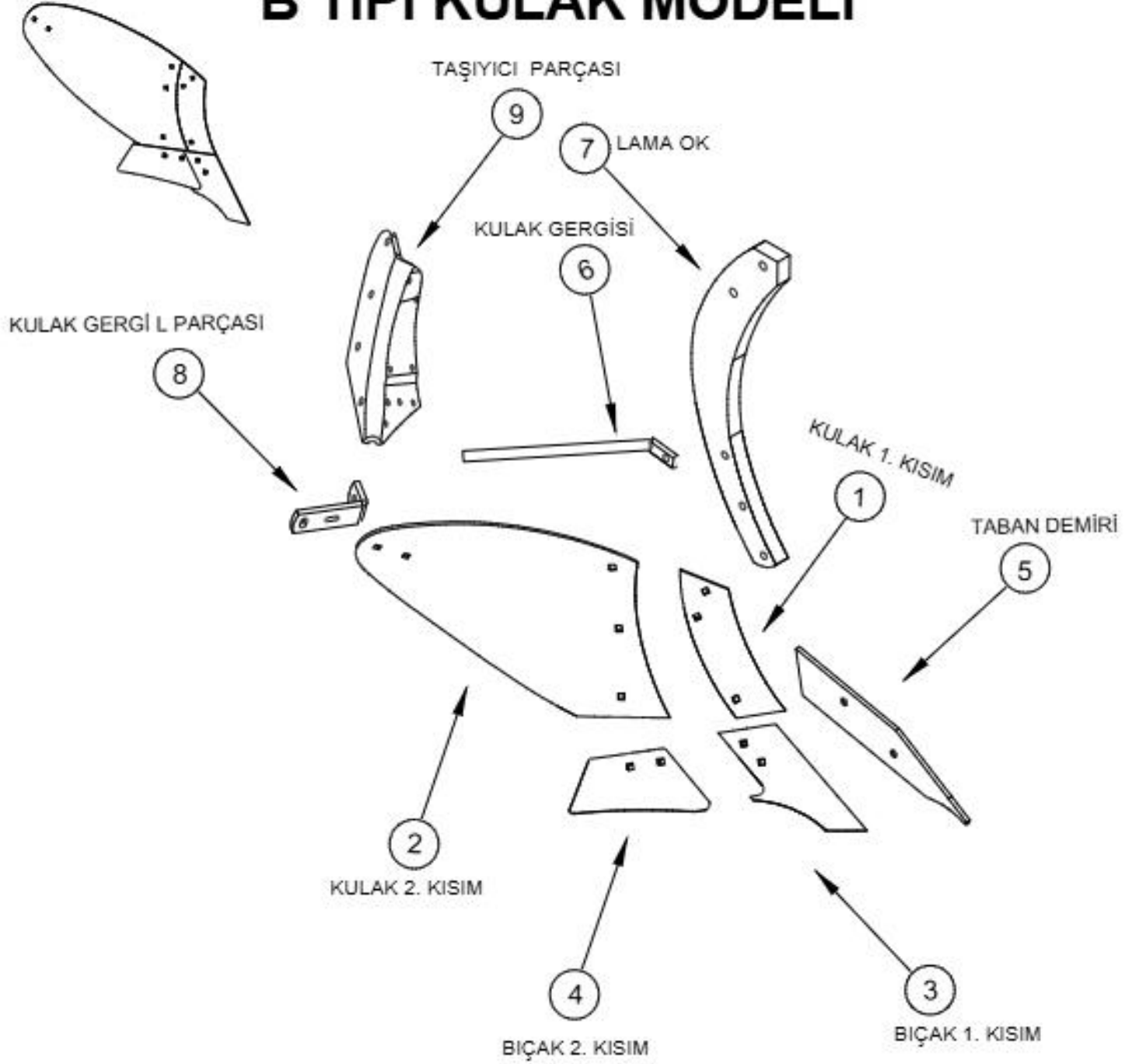

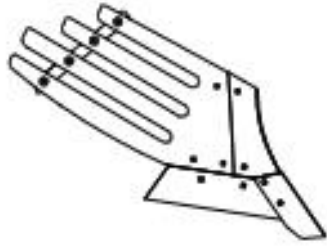

C TİPİ KULAK MODELİ

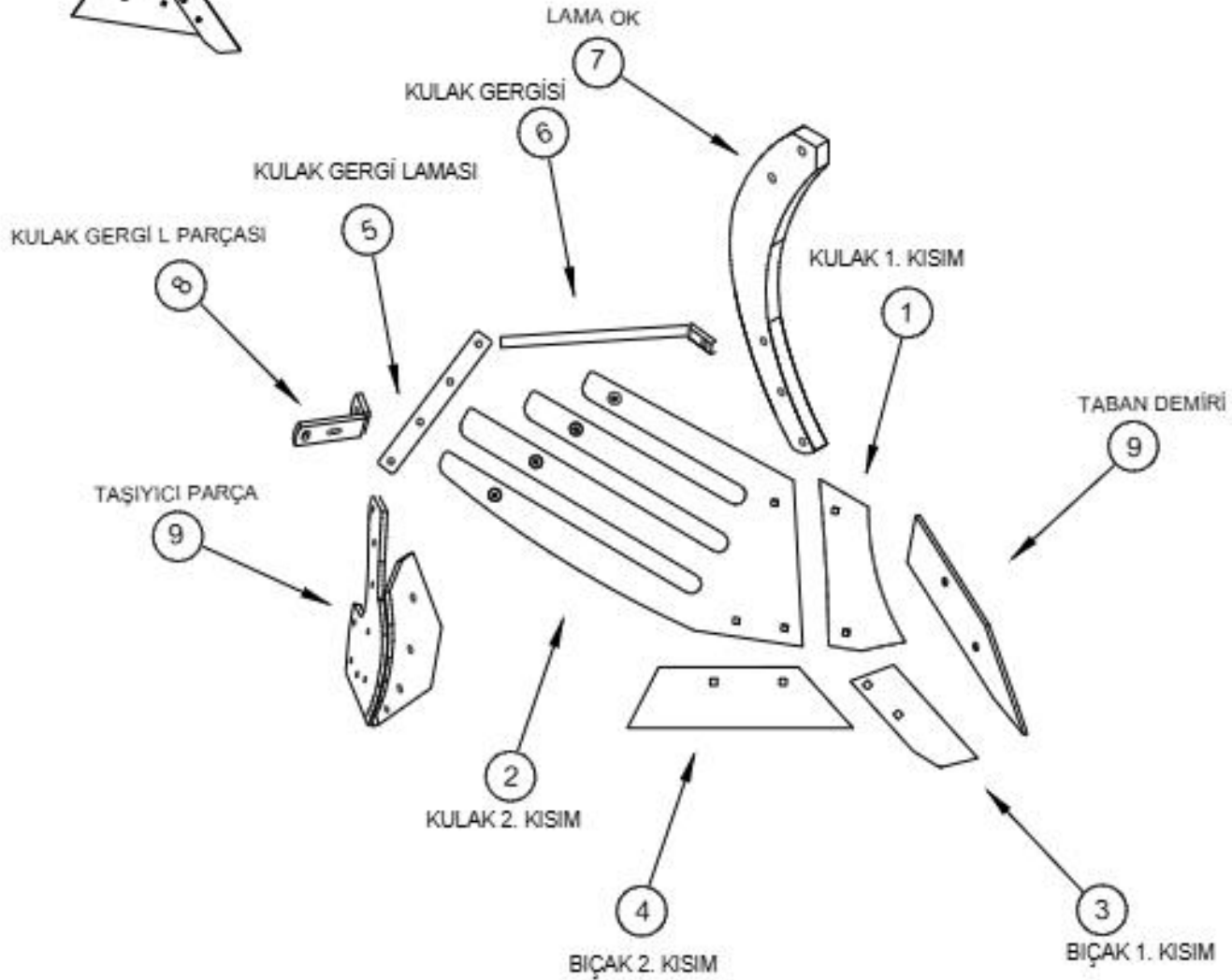

D TİPİ KULAK MODELİ

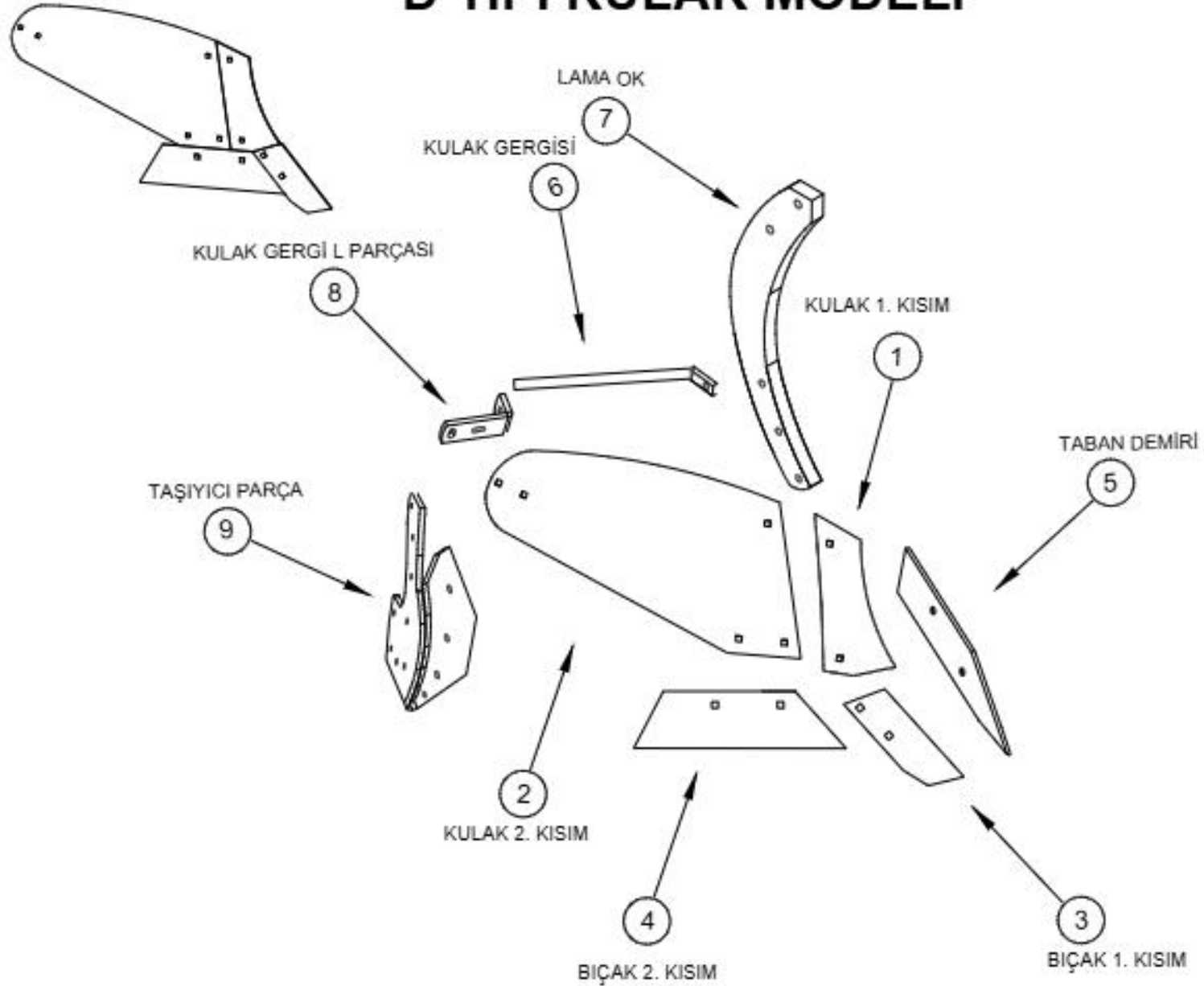

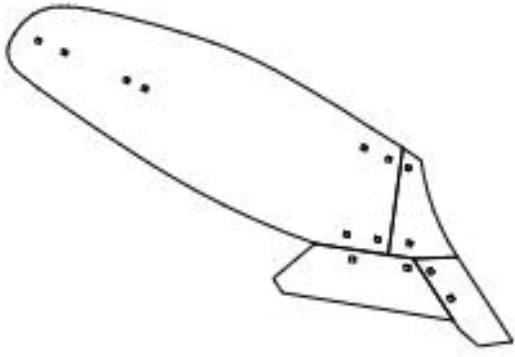

E TİPİ KULAK MODELİ

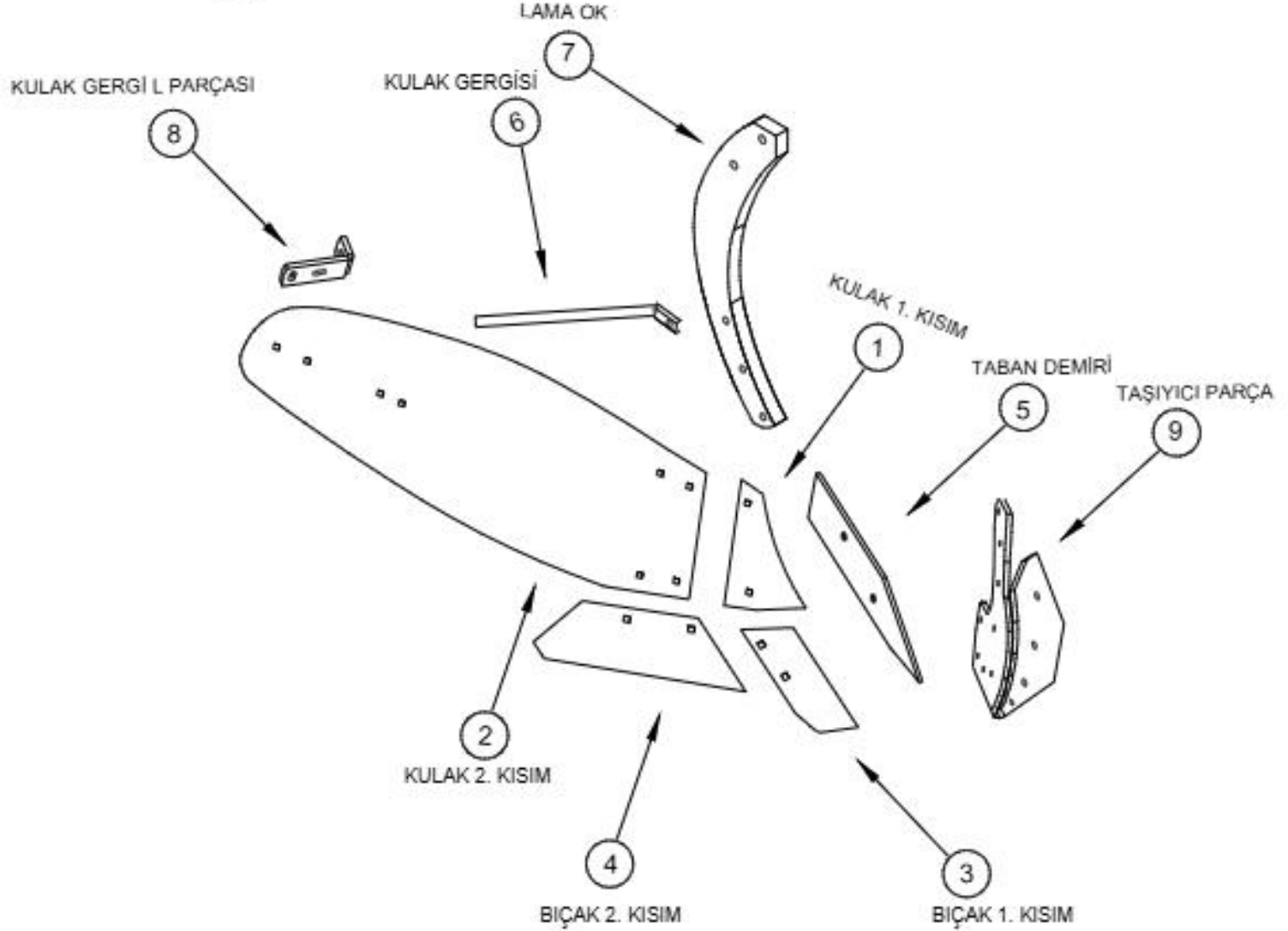

F TİPİ KULAK MODELİ

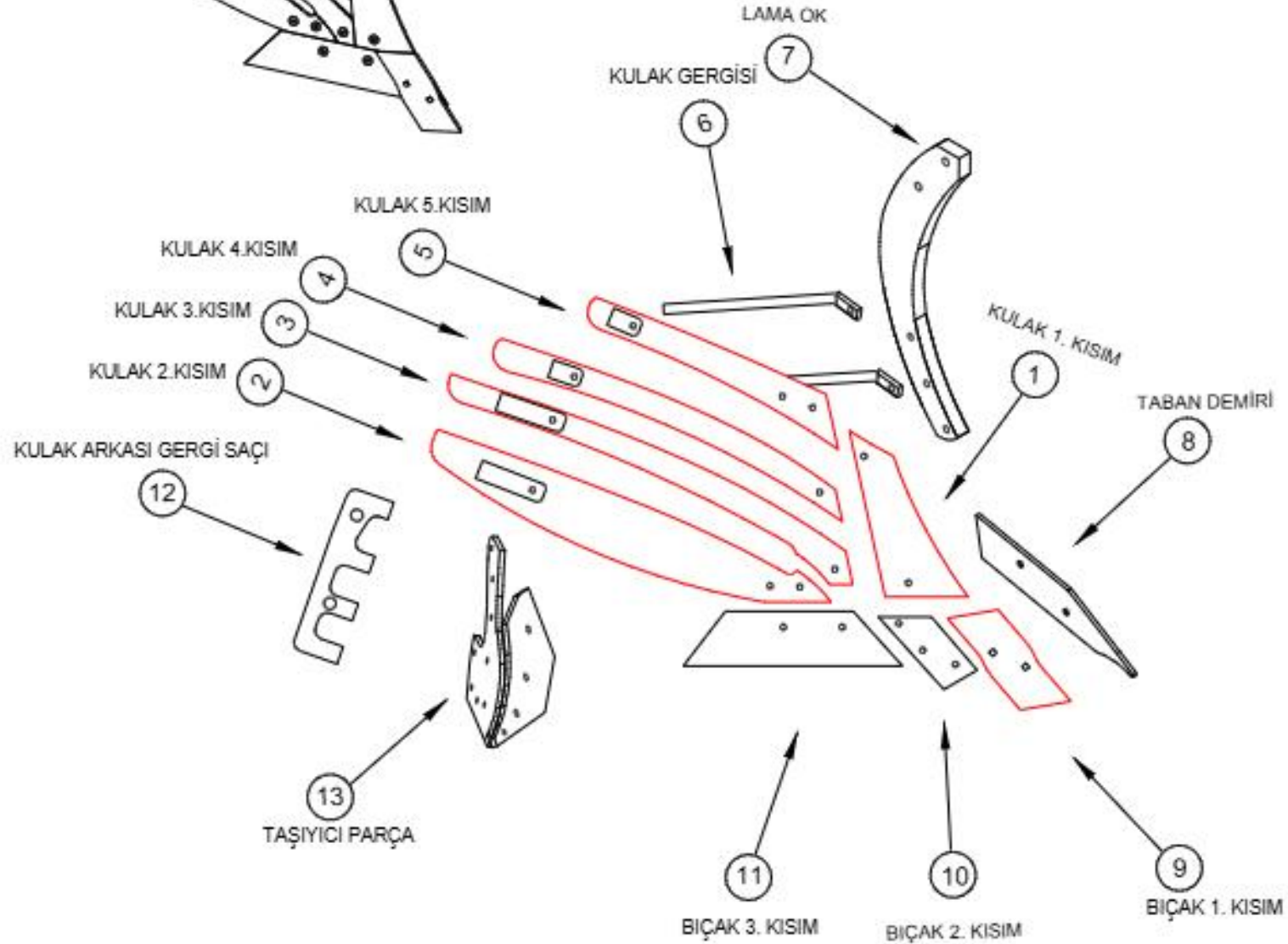

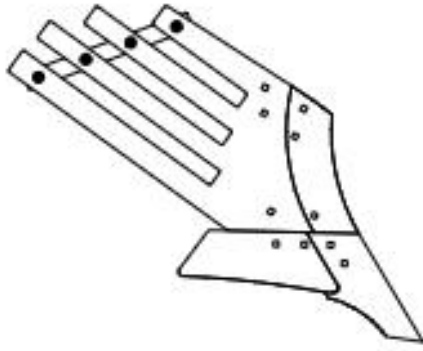

G TİPİ KULAK MODELİ

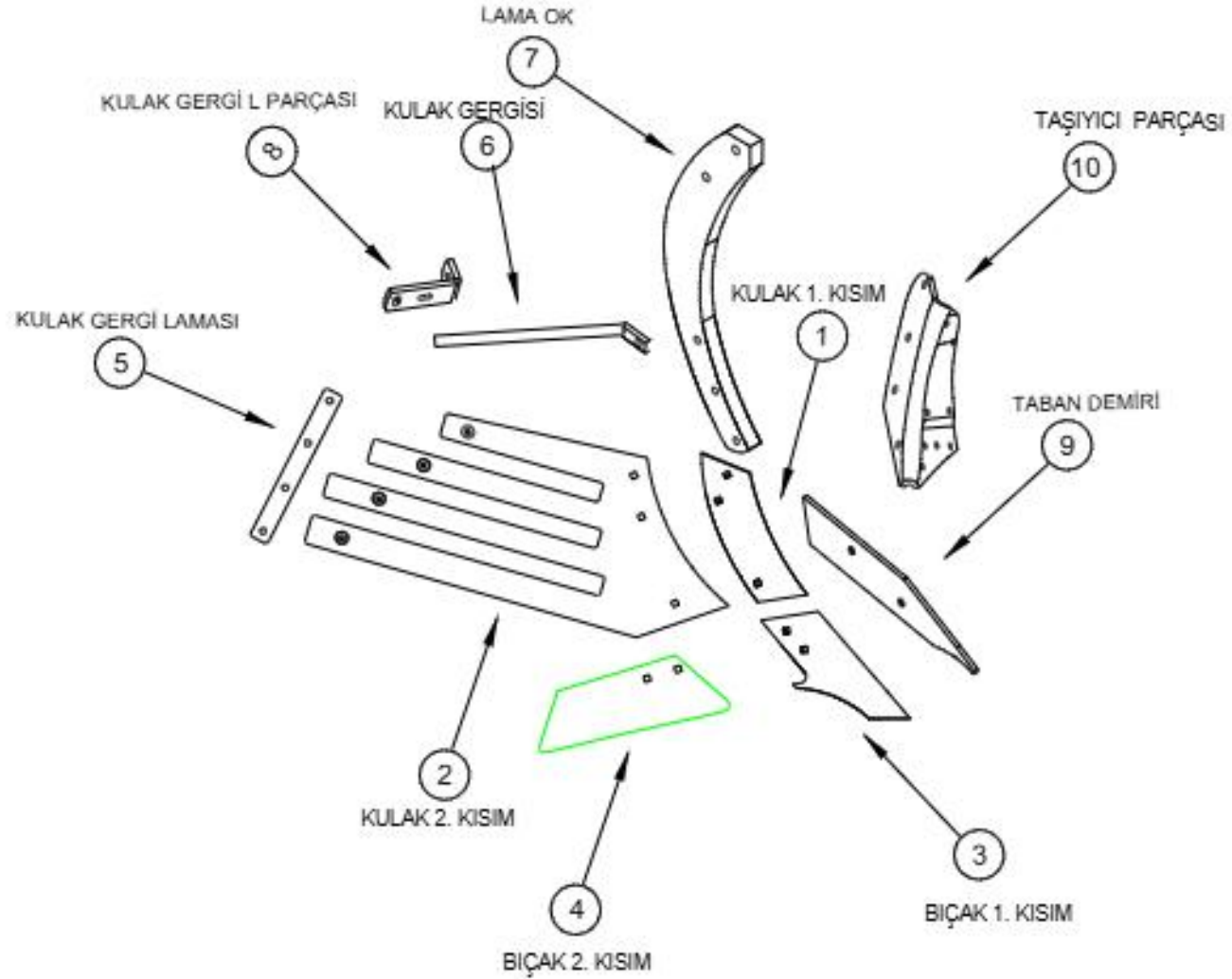

H TİPİ KULAK MODELİ

